

**DRAFT ISSUE**  
FOR DISCUSSION PURPOSES

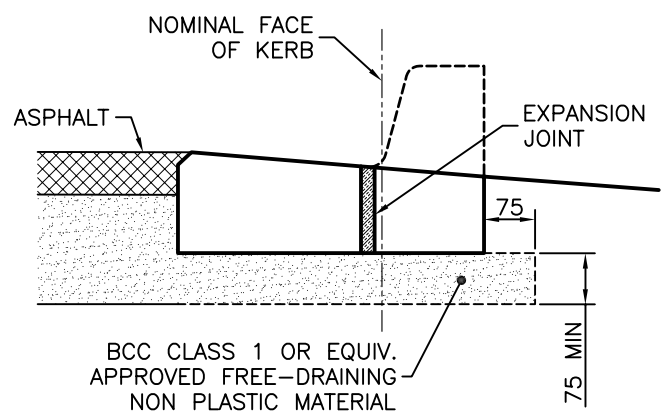

**SECTION A-A**  
(FOR TYPE 'E' K&C)

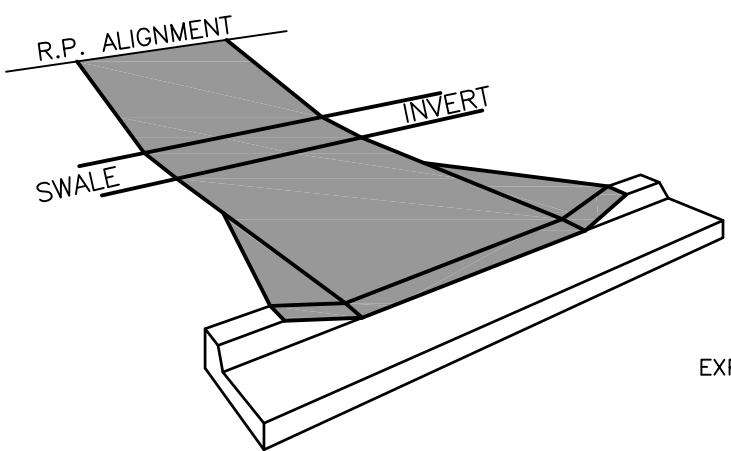

**PERSPECTIVE VIEW**  
(ALTERNATE TYPE '1' SWALE)

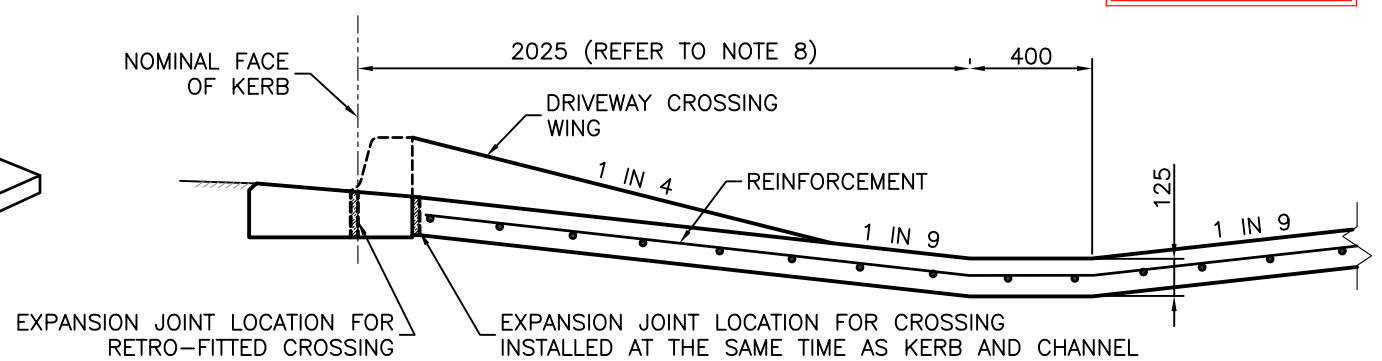

**SECTION**  
(WITH TYPE 'E' KERB AND CHANNEL)

**DRAFT ISSUE**  
FOR DISCUSSION PURPOSES

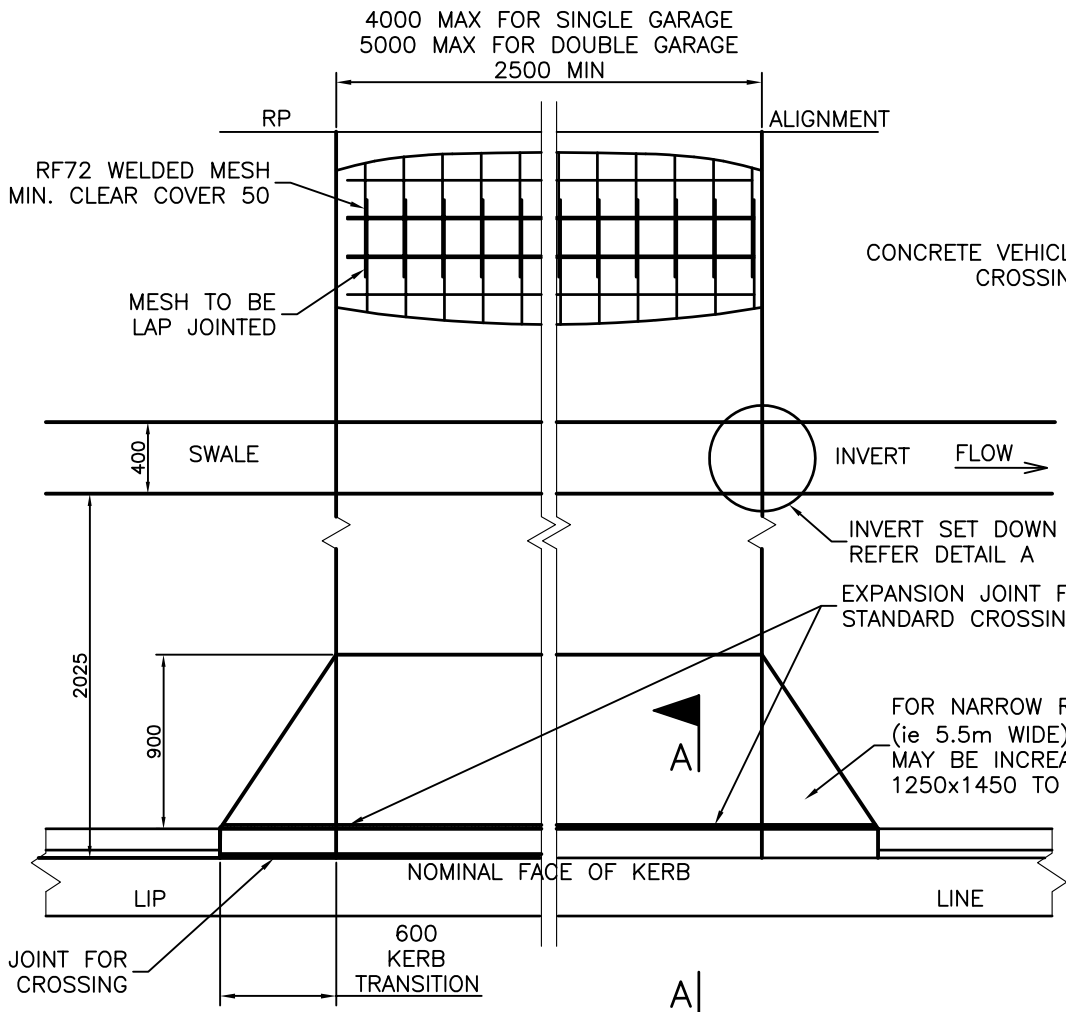

TYPE 'E' K&C

**PLAN**

TYPE 'G' KERB

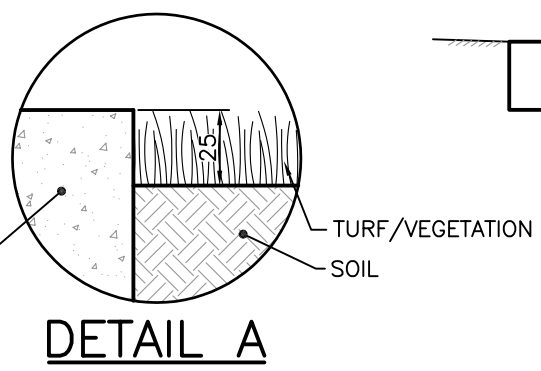

**DETAIL A**

**DRAFT ISSUE**  
FOR DISCUSSION PURPOSES

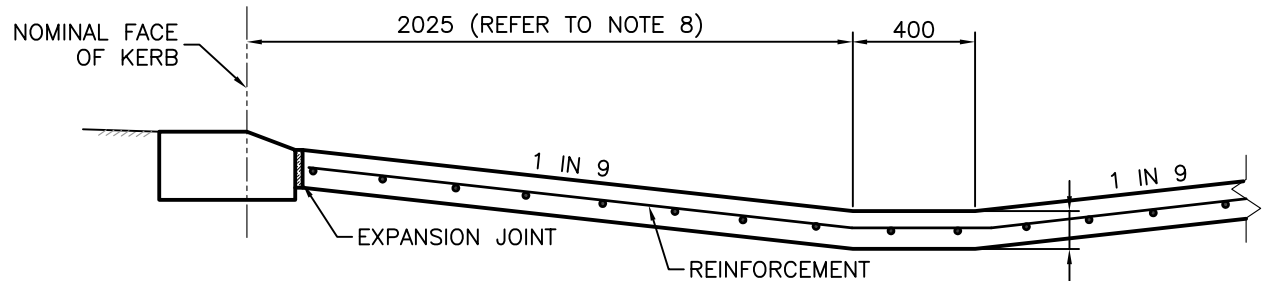

**SECTION**  
(WITH TYPE 'G' KERB)

**NOTES:**

1. THE SPECIFIED PAVEMENT STANDARD DOES NOT APPLY TO POOR SUBGRADE. REFER SUPPLEMENTARY NOTES FOR DETAIL.
2. THIS CROSSING IS NOT FOR COMMERCIAL VEHICLES.
3. ALL CONCRETE TO BE GRADE N25 (MIN.).
4. ALL CONCRETE TO BE BROOM FINISHED. FOR SLIP RESISTANCE REQUIREMENTS. REFER SPECIFICATION S150-ROADWORKS.
5. EXPANSION JOINTS TO BE FULL DEPTH 10 THICK CLOSED CELL CROSS LINKED POLYETHYLENE FOAM (85-150kg/m<sup>3</sup>). SEAL SURFACE OF JOINT WITH A SUITABLE POLYURETHANE SEALANT.
6. THE THICKNESS OF DECORATIVE SURFACING, WHERE APPROVED, IS ADDITIONAL TO THE THICKNESS SHOWN.
7. PERMITS RELATING TO ROADS AND DRAINAGE MUST BE OBTAINED FROM DEVELOPMENT AND REGULATORY SERVICES TO FOR APPROVAL OF PROPOSED VEHICLE CROSSING LOCATION AND LEVELS PRIOR TO ANY EXCAVATION.
8. DISTANCE FROM NOMINAL FACE OF KERB MAY VARY WITH SWALE WIDTH. GRADES ARE RECOMMENDED MAXIMUMS FOR VEHICLE ACCESS.
9. DIMENSIONS IN MILLIMETRES (U.N.O.).

**DRAFT ISSUE**  
FOR DISCUSSION PURPOSES

**DRAFT DESIGN APPROVED FOR ISSUE**  
SIGNATURE : P Cotton signature on original DATE : 03/09/04  
MANAGER INFRASTRUCTURE MANAGEMENT - R.P.E.Q. - 2546

**DRAFT ISSUE**  
FOR DISCUSSION PURPOSES

DFT2	NEW DRIVEWAY PROFILE & EXPANSION JOINTS ADDED	FEB '05	KP '05	PC '05
DRAFT	DRAFT ISSUE FOR DISCUSSION	JUN '03	JUL '04	JUL '04
ISSUE	AMENDMENT	DRAWN DATE	CHK'D DATE	APPR'D DATE

DESIGN AUTHORISED FOR ISSUE	DESIGN	CD/UMD	DATE	Jun '03
MANAGER INFRASTRUCTURE MANAGEMENT	DRAWN	CD/UMD	DATE	Jun '03
DESIGN APPROVED	CHECKED	IM - UMD	DATE	Jul '04
PRINCIPAL ENGINEER	DRAWING FILENAME	UMS 152 (DRAFT)		
STRATEGIC INFRASTRUCTURE MANAGEMENT	ASSOCIATED PLANS			



**BRISBANE CITY COUNCIL - URBAN MANAGEMENT DIVISION**

**WATER SENSITIVE URBAN DESIGN VEHICLE CROSSING (SLAB) FOR SINGLE DWELLING**

SCALE: NOT TO SCALE  
DWG No. **UMS 152**  
ORIGINAL SIZE: A3 REVISION: DFT2