

SQUARE OR CIRCULAR FORMWORK TO BE USED AT TOP OF FOOTING. CONCRETE TO SLOPE 25 AWAY FROM POST. EXTEND FORMWORK TO FULL DEPTH IN COLLAPSIBLE SOILS OR WHERE DIRECTED

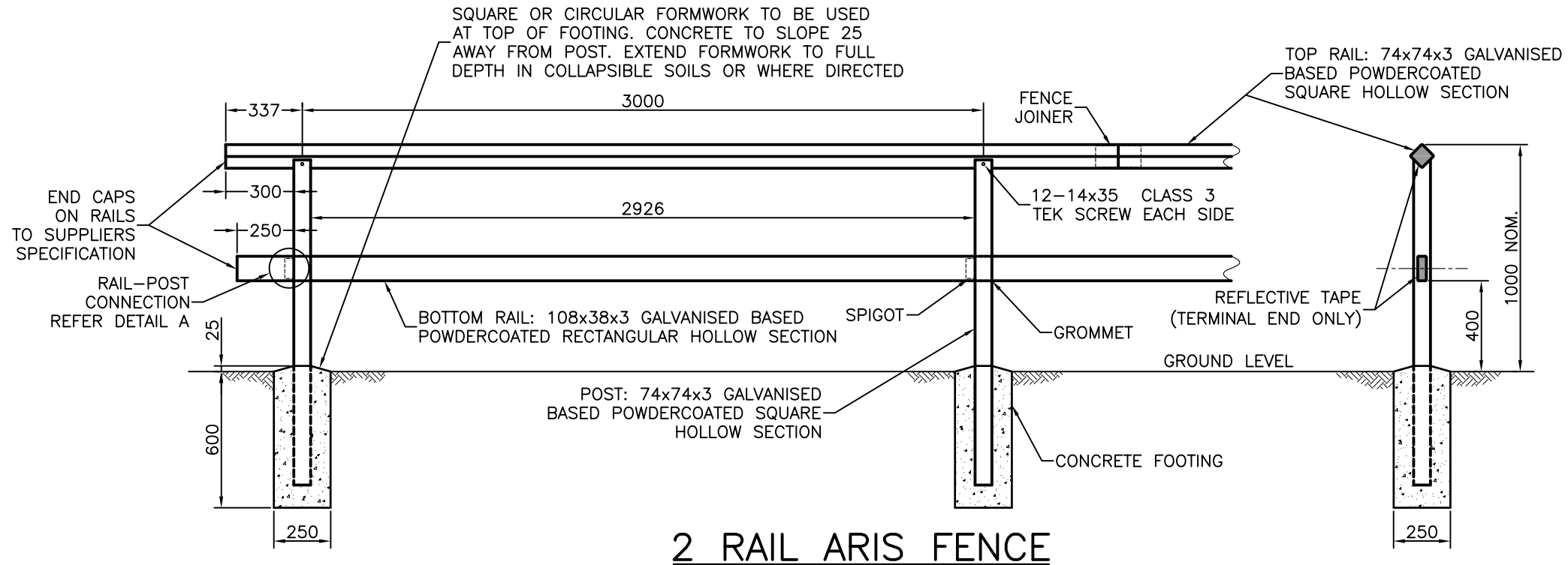

2 RAIL ARIS FENCE

NOTES:

1. THIS STANDARD IS NOT FOR USE IN A MARINE ENVIRONMENT. THE MARINE ENVIRONMENT COULD EXTEND UP TO 1km FROM THE FORESHORE.
2. POSTS AND ARIS FENCE TOP RAIL TO BE 74x74 GALVANISED BASED COLORBOND SQUARE HOLLOW SECTION.
3. ALL OTHER RAILS TO BE 108x38 GALVANISED BASED COLORBOND RECTANGULAR HOLLOW SECTION
4. JOINTS AND CONNECTIONS TO MANUFACTURERS SPECIFICATIONS.
5. POSTS TO BE VERTICAL.
6. ALL CONCRETE TO BE GRADE N25.
7. TWO RAIL POST AND RAIL FENCES GENERALLY USED AS PEDESTRIAN PROTECTION ABOVE CULVERTS AND EMBANKMENTS AND AS VEHICLE DELINEATION ALONG SPLIT-LEVEL STREETS.
8. THESE FENCES ARE INTENDED AS A PEDESTRIAN BARRIER AND DELINEATION DEVICE AND ARE NOT TO BE USED IN SITUATIONS WHERE VEHICLES REQUIRE RESTRAINT.
9. STEEL POSTS AND RAILS MAYBE POWDER COATED TO AS 4506 TO MATCH COLOUR CO-ORDINATION IN THE AREA (IN ACCORDANCE WITH BCC CORPORATE COLOUR PALETTE, REFER UMS 113).
10. 100mm WIDE REFLECTIVE TAPE TO BE APPLIED TO END POSTS AND/OR TERMINAL END OF RAILS WHERE VEHICLE TRAFFIC CONFLICT MAY OCCUR.
11. DIMENSIONS IN MILLIMETRES (U.N.O.).

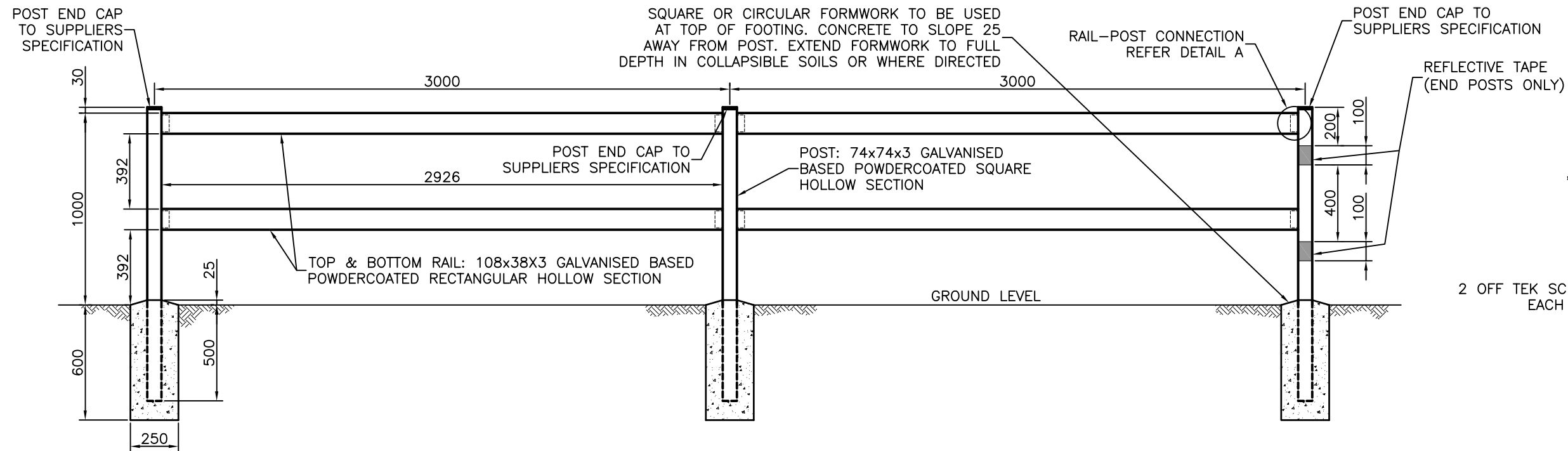

2 RAIL FENCE

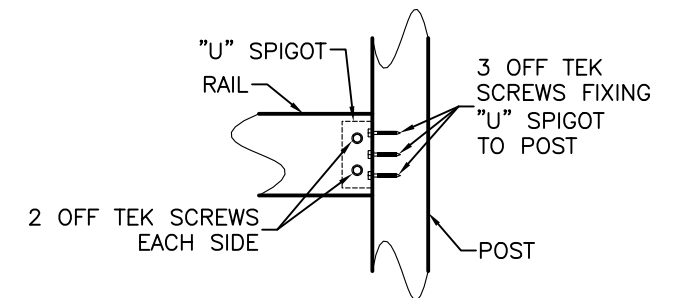

DETAIL A

ISSUE	AMENDMENT	DRAWN DATE	CHK'D DATE	APPR'D DATE
A	ORIGINAL ISSUE	Feb '04	Mar '05	Mar '05

DESIGN AUTHORIZED FOR ISSUE PAUL COTTON SIGNATURE ON ORIGINAL DATED 03/03/05	DESIGN	UMD - IM (DL)	DATE	Feb '04
MANAGER INFRASTRUCTURE MANAGEMENT R.P.E.Q.: 2546	DRAWN	UMD - IM (DL)	DATE	Feb '04
DESIGN APPROVED BRUCE HANSEN SIGNATURE ON ORIGINAL DATED Mar '05	CHECKED	BH	DATE	Mar '05
PRINCIPAL ENGINEER STRATEGIC INFRASTRUCTURE MANAGEMENT	DRAWING FILENAME	UMS 248		
	ASSOCIATED PLANS			



BRISBANE CITY COUNCIL - URBAN MANAGEMENT DIVISION

**TWO RAIL,
STEEL HOLLOW SECTION
POST AND RAIL FENCE**

SCALE	NOT TO SCALE
DWG No.	UMS 248
ORIGINAL SIZE	A3
REVISION	A