

RECESSED BUS BAY - GEOMETRIC LAYOUT

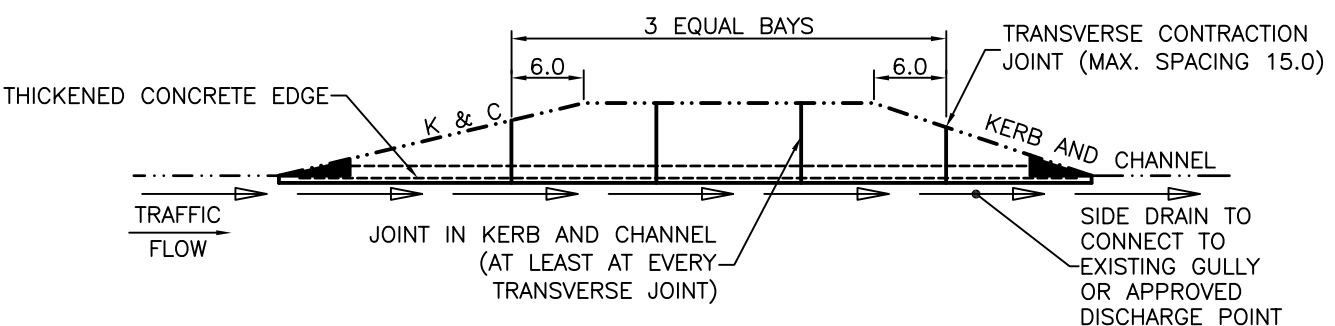

RECESSED BUS BAY - PAVEMENT JOINT LAYOUT

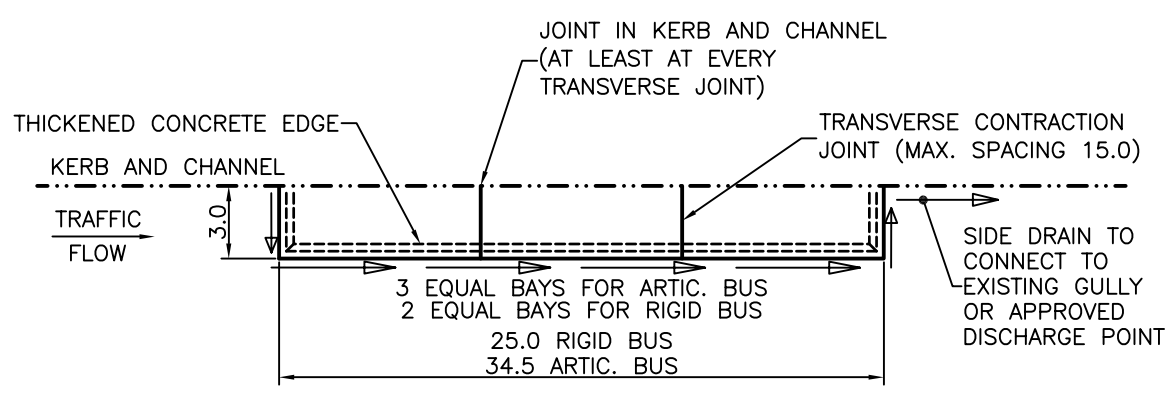

NON-RECESSED BUS BAY AND PAVEMENT JOINT LAYOUT

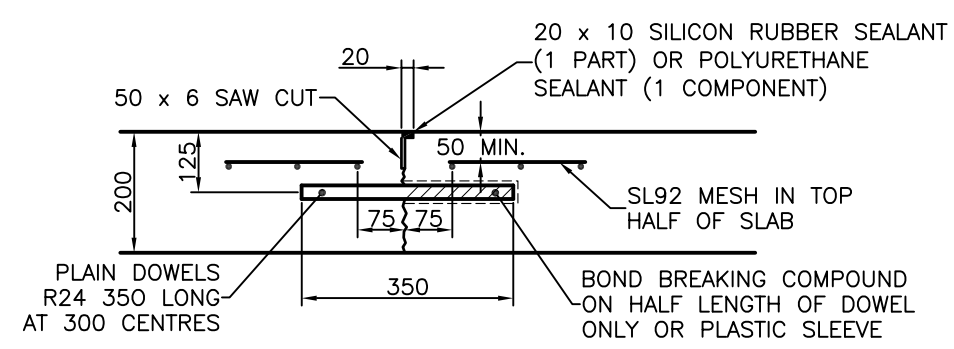

TRANSVERSE CONTRACTION JOINT

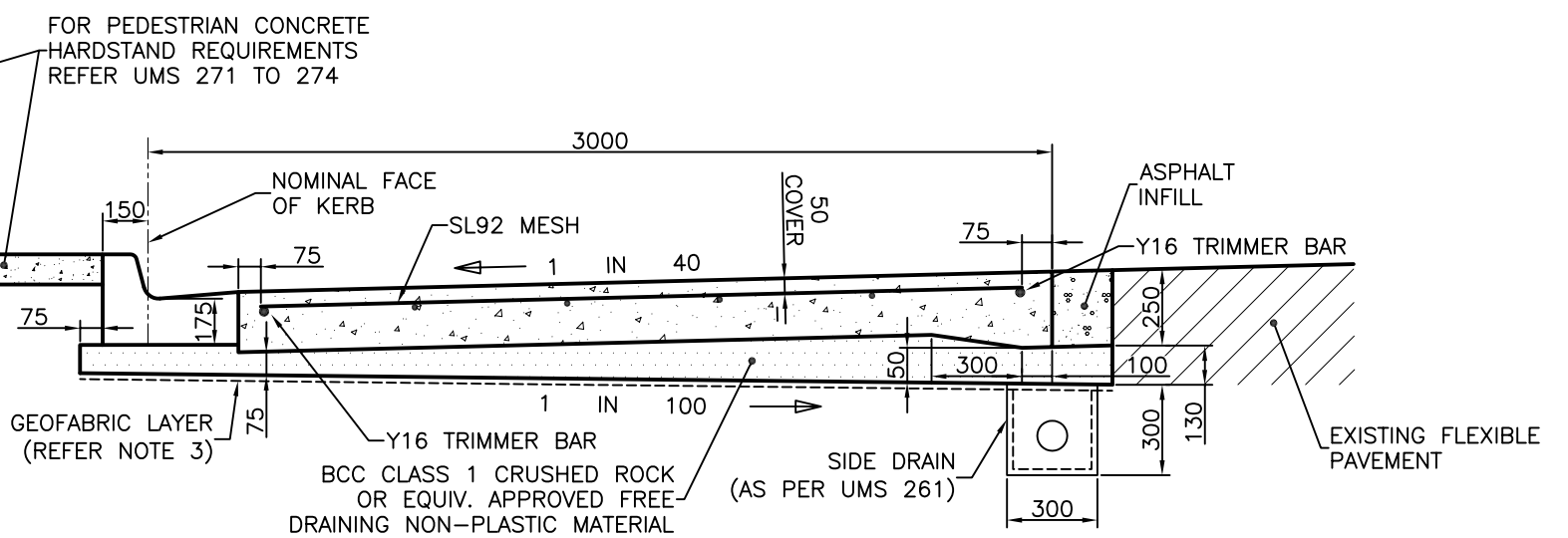

CONNECTION TO EXISTING FLEXIBLE PAVEMENT

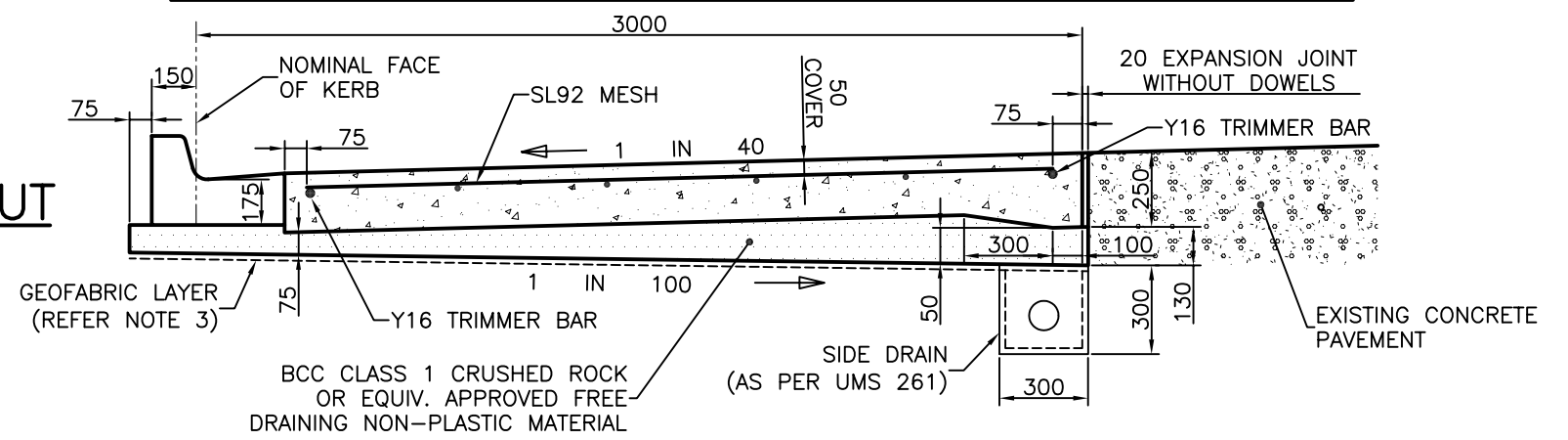

CONNECTION TO EXISTING CONCRETE PAVEMENT

NOTES:

1. THE SPECIFIED PAVEMENT STANDARD DOES NOT APPLY TO POOR SUBGRADE. REFER SUPPLEMENTARY NOTES FOR DETAIL.
2. THE PAVEMENT DESIGN ASSUMES A MINIMUM SUBGRADE CBR OF 5 (SOAKED 4 DAYS).
3. A GEOFABRIC LAYER (BCC TYPE 3 ie. BIDIM A49 OR EQUIVALENT) SHALL BE USED WHERE THE SUBGRADE CBR IS <5 AND FOR SILTY/CLAYEY SOILS.
4. BUS BAY CONCRETE TO BE GRADE N32. PEDESTRIAN HARDSTAND CONCRETE TO BE GRADE N25.
5. CONCRETE TO BE BROOM FINISHED AND HAVE A MAXIMUM AGGREGATE SIZE OF 20mm.
6. REINFORCEMENT TO COMPLY WITH AS1303 FOR PLAIN BARS AND AS1304 FOR WELDED FABRIC. LAP MESH 400 AND TIE AT 500 SPACINGS.
7. WHERE A BUS BAY IS CONSTRUCTED ADJACENT TO AN EXISTING CONCRETE PAVEMENT, THE TRANSVERSE JOINTS IN THE BUS BAY SHALL LINE UP WITH THOSE IN THE EXISTING PAVEMENT.
8. IF A GULLY IS REQUIRED, IT SHOULD BE LOCATED SO AS TO INTERCEPT ANY WATER BEFORE IT REACHES THE BUS BAY. IF IT IS NECESSARY TO LOCATE A GULLY WITHIN THE LENGTH OF THE BUS BAY, THE GULLY SURROUND SHALL BE COMPLETELY ISOLATED FROM THE SURROUNDING PAVEMENT FOR THE FULL DEPTH OF THE PAVEMENT BY A BITUMEN IMPREGNATED FIBREBOARD OR EQUIVALENT. ALSO A THICKENED EDGE SHALL APPLY TO THE SURROUNDING BUS BAY EDGE.
9. ALTERNATIVE DESIGNS MAY BE CONSIDERED FOR APPROVAL BY THE MANAGER, CITY ASSETS BRANCH UPON RECEIPT OF A FORMAL SUBMISSION BY A CERTIFIED ENGINEER.
10. DECIMALISED DIMENSIONS IN METRES, WHOLE NUMBER DIMENSIONS IN MILLIMETRES.

ISSUE	AMENDMENT	DRAWN DATE	CHK'D DATE	APPR'D DATE
B	Ped Hardstand Requirement & Note 9 Modified	DJL 10/05	BH 13/03/06	PC 21/03/06
A	ORIGINAL ISSUE	April '01	May '01	June '01

DESIGN AUTHORIZED FOR ISSUE B. BALL SIGNATURE ON ORIGINAL DATED 29/6/01	DESIGN	STD DWG GROUP	DATE	April '01
MANAGER ASSET SUPPORT - R.P.E.O. 3 8 5 2	DRAWN	CITY DESIGN	DATE	April '01
DESIGN APPROVED B. HANSEN SIGNATURE ON ORIGINAL DATED 27/6/01	CHECKED	M. STEER	DATE	May '01
PRINCIPAL ASSET OFFICER ROADS & DRAINAGE	DRAWING FILENAME	UIMS 263	ASSOCIATED PLANS	SUPERSEDES WS 17-3



BRISBANE CITY COUNCIL - URBAN MANAGEMENT DIVISION

BUS BAY SLAB STANDARD CROSSFALL

SCALE: NOT TO SCALE
DWG No. UMS 263
ORIGINAL SIZE: A3 REVISION: B