

DETAIL A – FEMALE TONGUE
SCALE 1:2

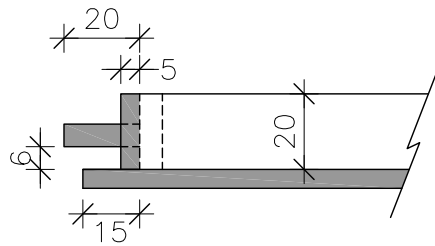

DETAIL B – MALE TONGUE
SCALE 1:2

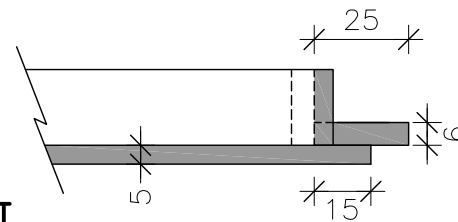

SET BACK 15mm ON FRONT
EDGE ONLY. 6mm BACK ON
ALL OTHER EDGES

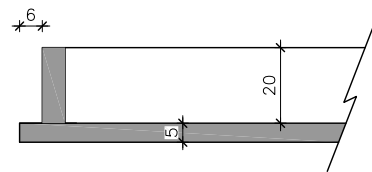

DETAIL C – SUPPORT BAR OFF SET
SCALE 1:2

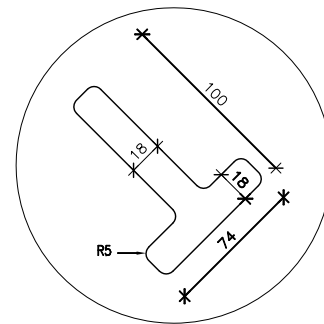

DETAIL D – TREE SPEAR CUT OUT DETAIL
SCALE 1:4

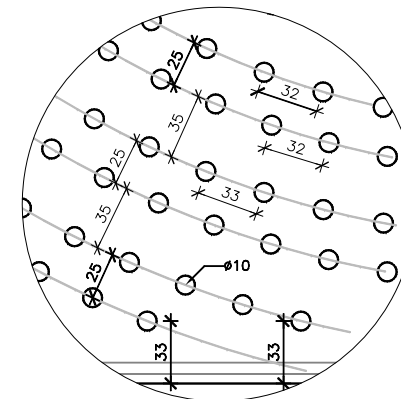

DETAIL E
SCALE 1:4

TREE GRATE CONSTRUCTION NOTES

- * TREE GRATE TO BE HOT SPRAYED GALVANISED PRIOR TO POWDER COATING
- * ALL WELDS TO BE MINIMUM 20mm IN LENGTH. ALL CORNERS TO HAVE VERTICAL DOWN WELDS
- * ALL SPLATTER & SLAG TO BE REMOVED PRIOR TO GALVANISING
- * HOLES ARE NOT TO BE WELDED OVER
- * ALL STRUCTURAL WELDS TO AS 1554
- * CENTRALISE CAM LOCK PLATE OVER 32Ø HOLE BEFORE WELDING IN PLACE 2 OF PER GRATE HALF
- * POWERCOAT COLOUR TO BE 'INTERPON D1000 SABLE BASS TEXTURE GN297A'

TREE GRATE HOLE SETOUT NOTES

- * LINE OFF SETS ARE STAGGERED BETWEEN 25mm & 35mm. GRATE EDGE TO CENTRE HOLE DISTANCE IS 33mm
- * CENTRE TO CENTRE HOLE DISTANCE IS APPROXIMATELY 32mm
- * DIVIDE HOLES PER LINE BY AMOUNTS OF HOLES NOT BY SET DISTANCES TO ACHIEVE A MORE UNIFORM HOLE PATTERN
- * HOLES TO BE 10mmØ

INSTALLATION NOTES

- * REFER TO UMS 516 'TREE PIT WITH GRATE' FOR SUPPORT FRAME AND INSTALLATION.

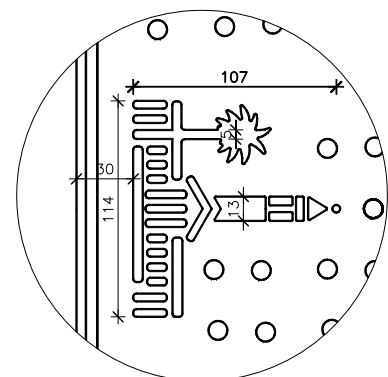

DETAIL F
SCALE 1:4

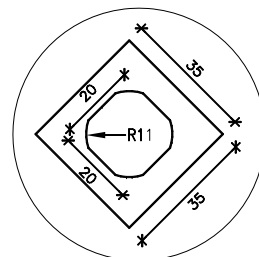

DETAIL G – CAM LOCK PLATE DETAIL
MATERIAL: 3mm STEEL (2 PER TREE HALF)
SCALE 1:4

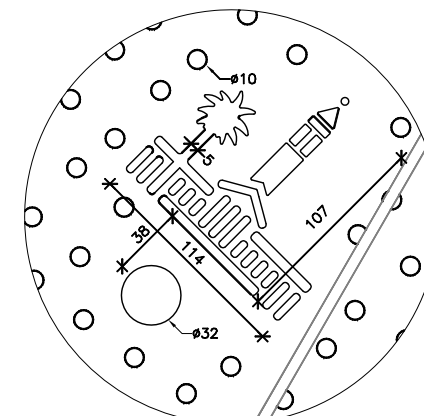

DETAIL H
SCALE 1:4

ISSUE	AMENDMENT	DRAWN DATE	CHK'D DATE	APPR'D DATE
B	Note Amendments	OCT '11	OCT '11	OCT '11
A	ORIGINAL ISSUE	DEC '10	DEC '10	DEC '10

DESIGN AUTHORISED FOR ISSUE			
FOR	MANAGER ASSET MANAGEMENT, R.P.E.Q: N/A	DESIGN	B.S.
DESIGN APPROVED	VICKI MARTIN SIGNATURE ON ORIGINAL 17/10/2011	DRAWN	D.S.
PRINCIPAL OFFICER	URBAN DESIGN UNIT	CHECKED	D.M.
		DRAWING FILENAME	UMS 519-2
		ASSOCIATED PLANS	UMS 519-1, UMS 519-3
		DATE	NOV '10
		DATE	DEC '10
		DATE	DEC '10



BRISBANE CITY COUNCIL STANDARD DRAWING

TREE GRATE DETAILS

SCALE: NOT TO SCALE
DWG No. **UMS 519-2**
ORIGINAL SIZE: A3 REVISION: B